

ZAZA2 PBJ 2

Brevet déposé/Patent deposit

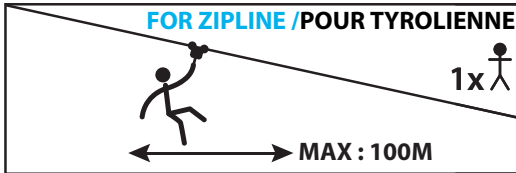
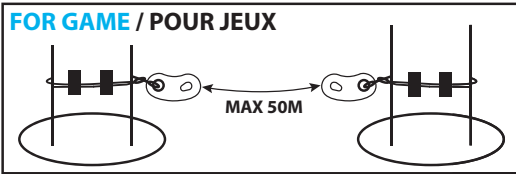

ADVANTAGES / AVANTAGES

- Facile et simple à installer
Easy to install
- 1 Sans SERRE-CÂBLE!
No CLAMP
- 1 Sans maintenance
No maintenance

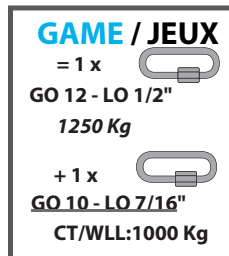
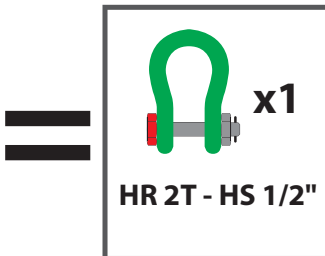
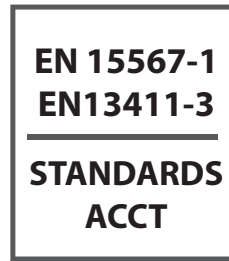
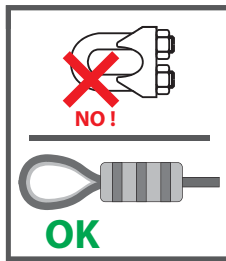

OU

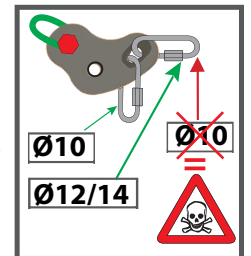
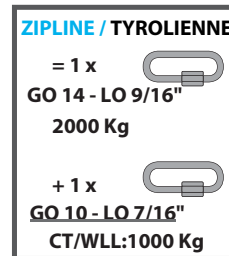

EXEMPLES DE SYSTEMES DE FIXATIONS FIXATION EXAMPLE

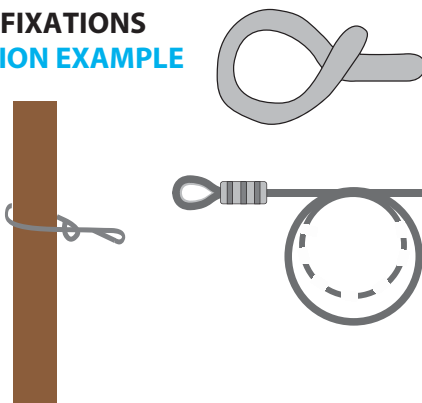

ROUND TEXTILE SLING TYPT "E" ELINGUE RONDE TEXTILE TYPE "E"

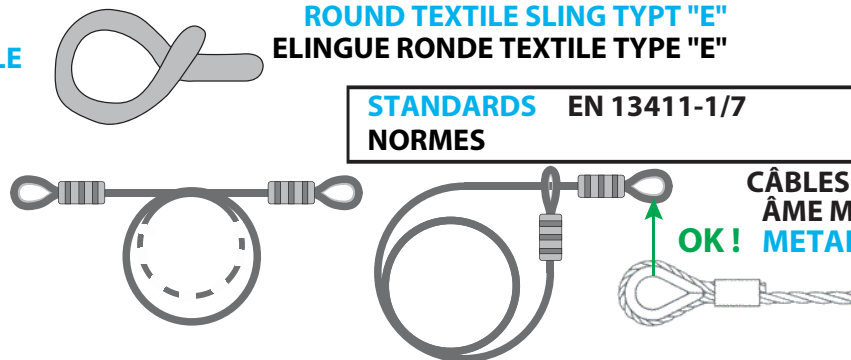

CÂBLES \varnothing 12 or 1/2"
ÂME METALLIQUE
OK! METALLIC CORE

Chain \varnothing 10
Grade 80 mini

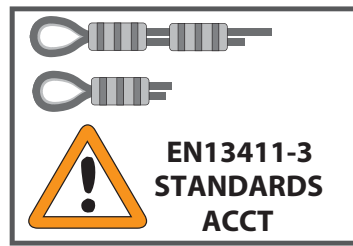

Operation 1

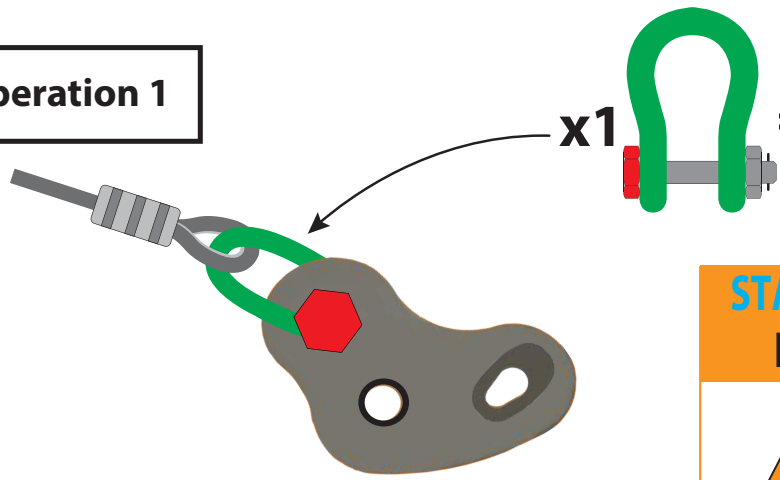

STANDARDS OF ASSEMBLY
NORMES DE MONTAGE



EN 15567-1
 EN 13411-3
 STANDARDS - ACCT

Operation 2

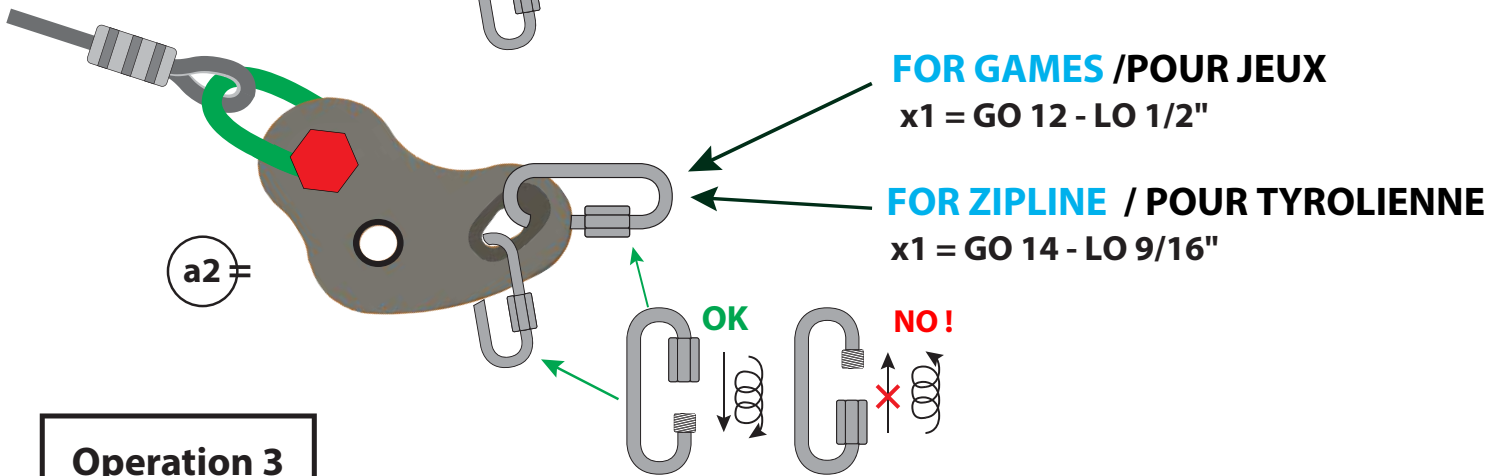
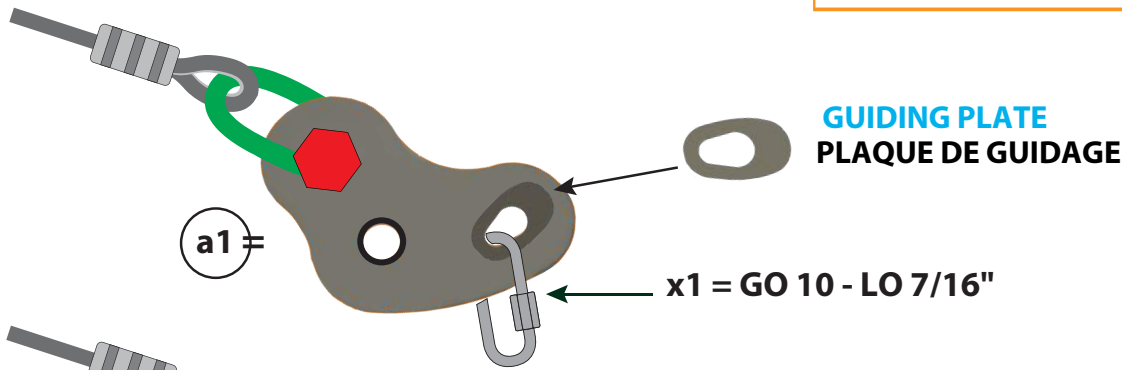

Operation 3

● INSTALLATION of STARTING PLATE
INSTALLATION DE LA PLATINE DE DEPART

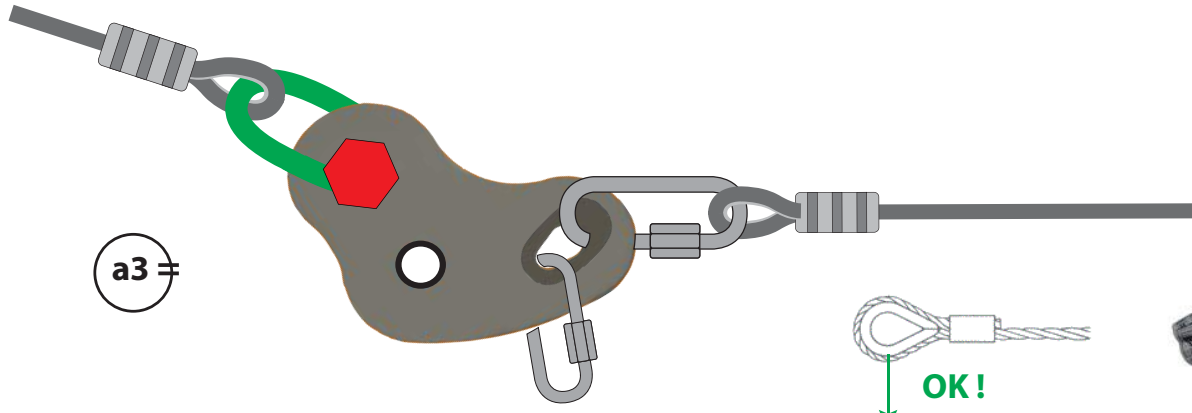

a3 =

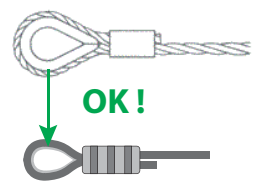

4 x 130KN



Operation 4

- **INSTALLATION of ARRIVALL PLATE**
INSTALLATION DE LA PLATINE D'ARRIVEE

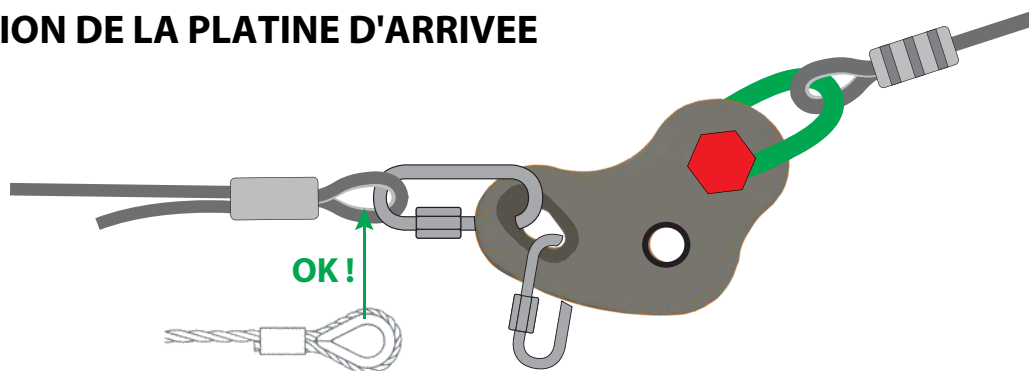

Operation 5

- **CABLE TENSION**
TENSION DU CÂBLE

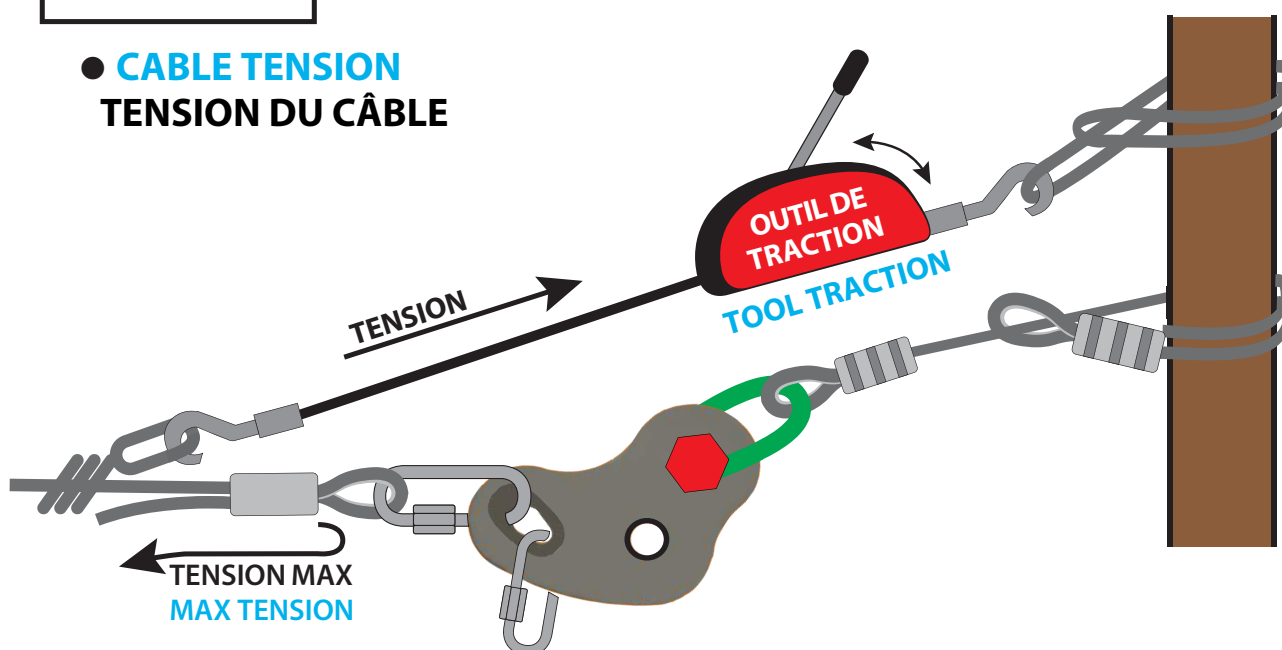

Operation 6

- **TO CRIMP / POUR SERTIR**

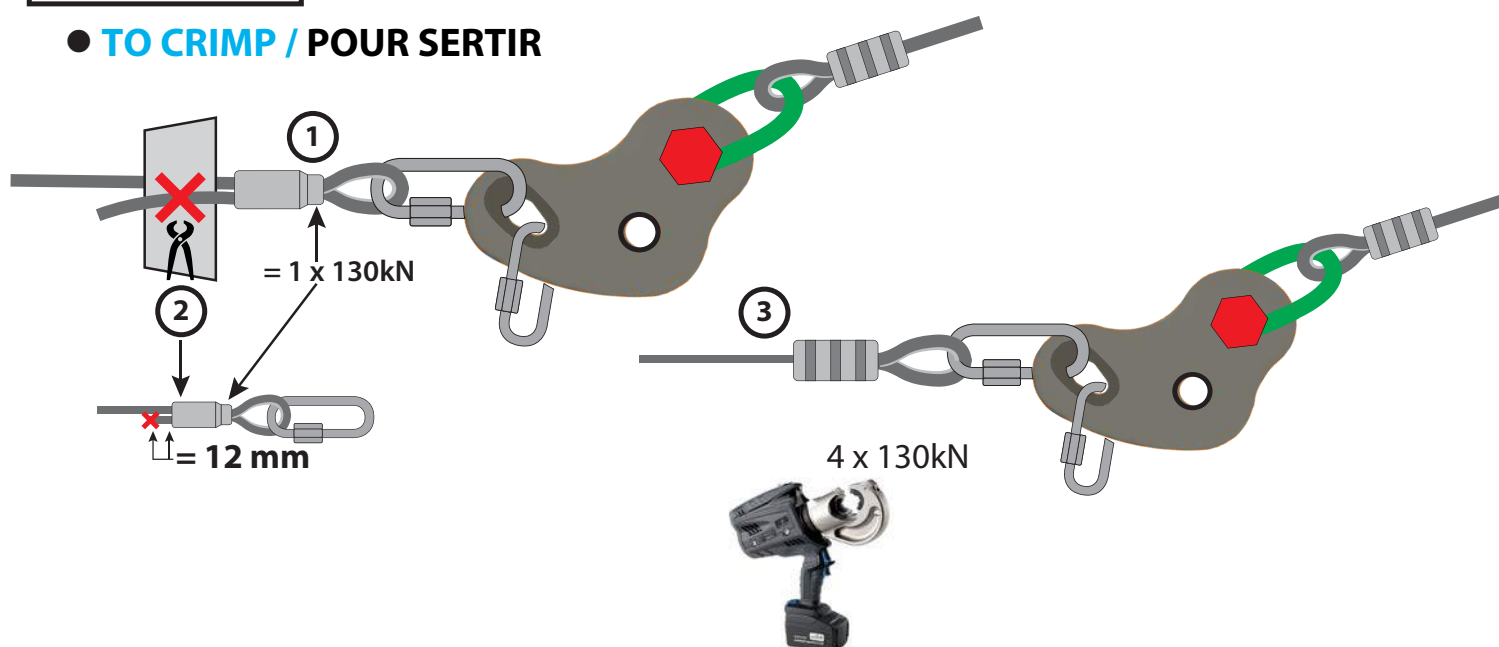

Operation 7

● TENSION SYSTEM FOR ZIPLINE / SYSTEME DE TENSION POUR TYROLIENNE

1

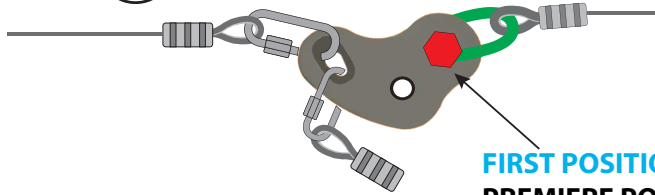

FIRST POSITION
PREMIERE POSITION

2

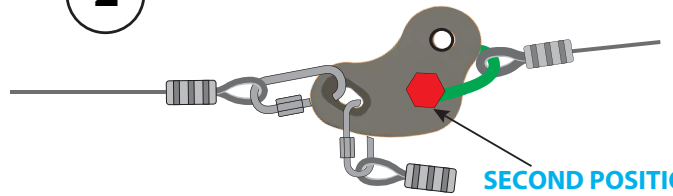

SECOND POSITION
DEUXIEME POSITION

Operation 8

● RECOMMANDATION ASSEMBLY / RECOMMANDATION DE MONTAGE

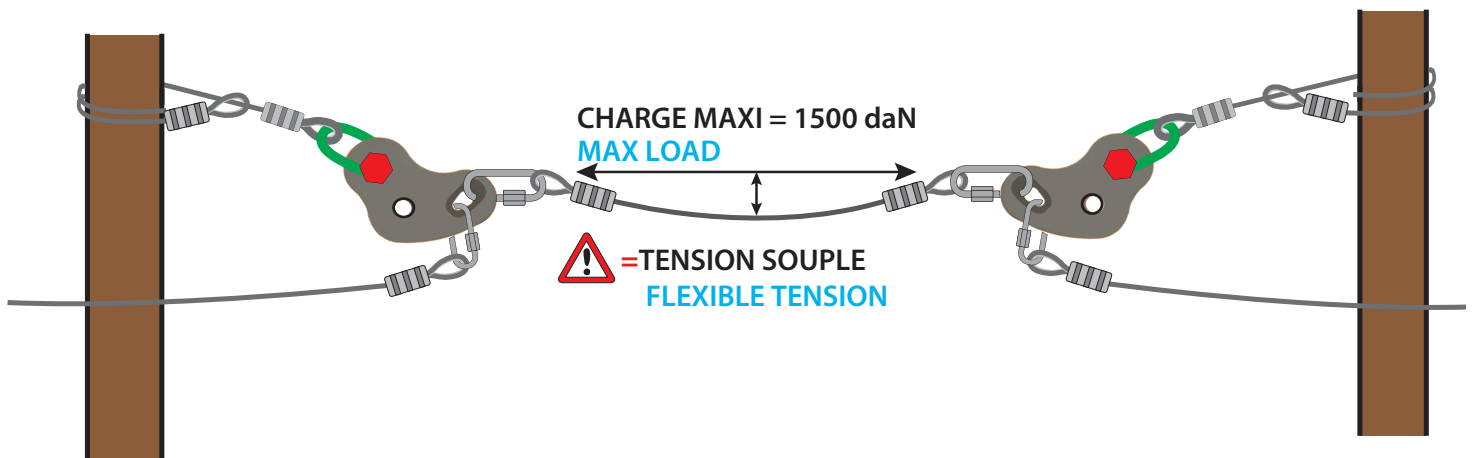

CHARGE MAXI = 1500 daN
MAX LOAD

⚠ = TENSION SOUPLE
FLEXIBLE TENSION

Operation 9

● JUNCTION / JONCTION

NOT contractual Examples
system for fixation
Exemples (non contractuel)
de systèmes de fixations

